

Application

Designed for use as drilled from solid bar stock thermowells for resistance thermometers and thermocouples. Threaded connection allows to assembly into process.

Features

- Process connection: thread G1/2", 1/2"NPT or others
- Instrument connection: thread G1/2", 1/2"NPT or others
- Immersion lengths: acc. to customer's specification
- Tolerances per DIN ISO 2768
- Maximal process pressure and temperature depends on thermowell dimension and material
- Thermowell materials:
1.4401 (AISI316), 1.4404 (AISI316L)
1.4541 (AISI321), 1.4571 (AISI316Ti)
2.4816 (Alloy 600), 2.4819 (Alloy C276)
2.4602 (Alloy C22), 3.7035 (Tytan gr. 2)

Options

- Certificate 3.1 acc. to EN 10204
- PMI test
- Designation with individual serial number
- Other materials, threads and dimensions
- Protective coatings: PFA, silicon carbide or others

Protective coatings

Additional protective coatings are commonly used in applications where resistance to abrasion, corrosion or erosion is critical.

This solution is also an alternative to expensive materials - it allows to lower production costs compared to thermowells made entirely of desired material. Coat can be applied for example to standard stainless steel AISI316L (1.4404).

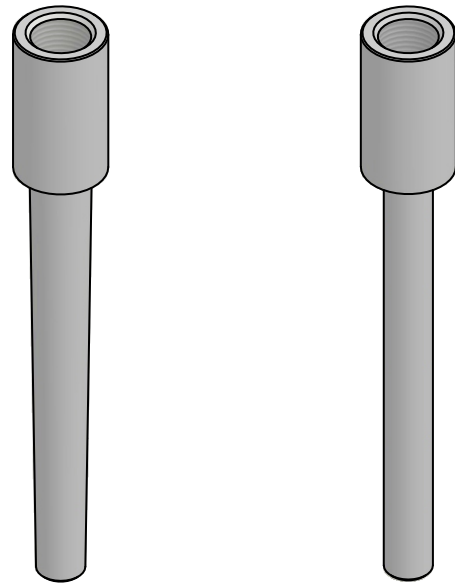

Drilled thermowells,
weld-in.
Type W-WWZ
(tapered)

Drilled thermowells,
weld-in.
Type W-WWP
(straight)

Rating depends on the parameters below:

- Process medium
- Process pressure and temperature
- Flow rate
- Design of thermowell (dimensions, material)

Termoaparatura Wrocław offers following protective coating materials:

- Teflon® PTFE/PFA
- Stellit®
- Hard chrome
- Silicon carbide SiC
- Aluminum oxide

Wake frequency calculations in accordance with ASME PTC 19.3 are recommended in critical applications. TERMOAPARATURA offer this as an engineering service.

Solid machined thermowells W-WWZ, W-WWP for weld in

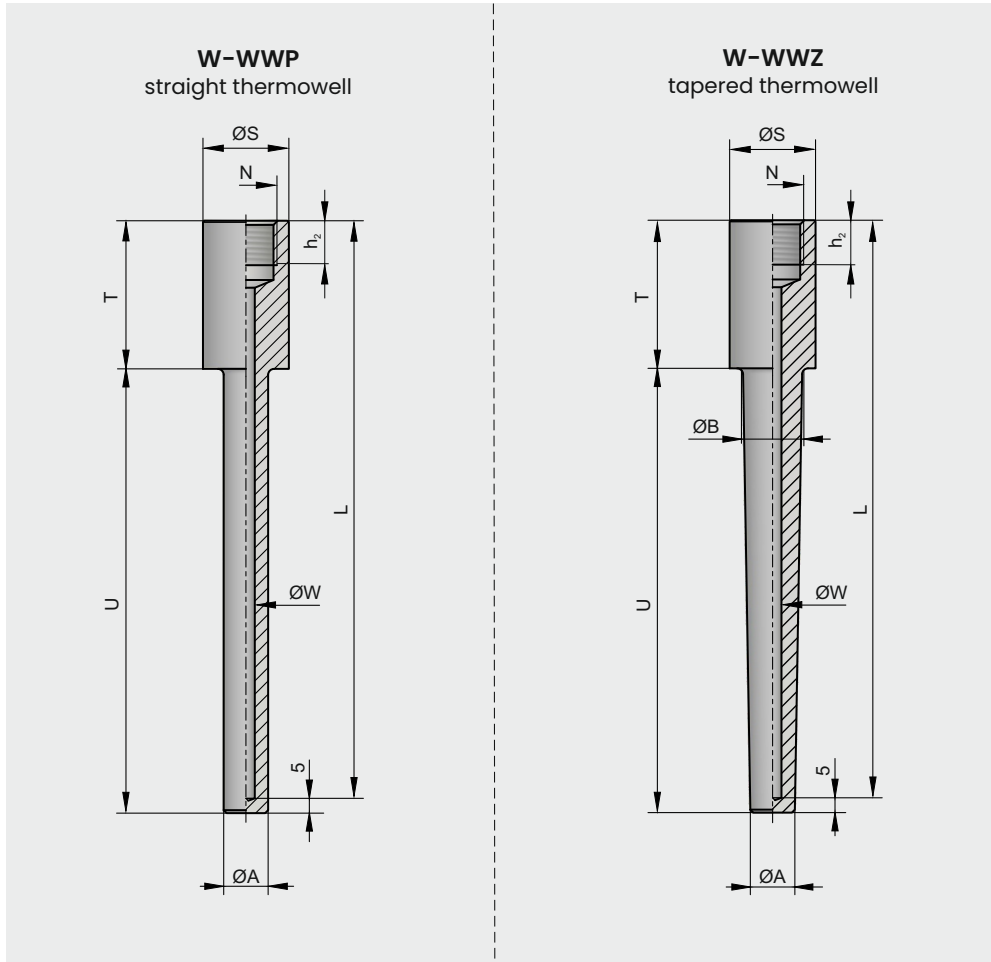

Standard dimensions

- Standard lengths of internal threads

Instrument connection N	Thread length h_2 [mm]
M14x1.5	17
M18x1.5	
M20x1.5	
G1/4"	
G1/2"	
1/2"NPT	18

Ordering code

W - WW 1 - 2 - 3 - 4 - 5 - 6 - 7 - 8 - 9

1	<input type="text"/>	Design	
		Z	thermowell weld-in, tapered
		P	thermowell weld-in, straight
2	<input type="text"/>	Thermowell material	
		xxx	specify material type
3	<input type="text"/>	Diameter A	
		xxx	to be specified in milimeters
4	<input type="text"/>	Diameter B (for thermowell W-WWP dimension B=A)	
		xxx	to be specified in milimeters
5	<input type="text"/>	Bore diameter W	
		xxx	to be specified in milimeters
6	<input type="text"/>	Instrument connection N	
		xxx	specify type of thread
7	<input type="text"/>	Immersion length U	
		xxx	to be specified in milimeters
8	<input type="text"/>	Length T	
		xxx	to be specified in milimeters
9	<input type="text"/>	Diameter S	
		xxx	to be specified in milimeters