

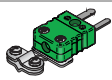
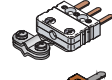

## MINIATURE CONNECTOR ACCESSORIES

### Cable clamp, Type S-090-M

S-090-M.. cable clamp for miniature connector provides optimal protection against pulling cable out. Unique construction allows to mounting cables of wide outside diameters range.

#### Order code

Cable clamp	for connector	
	S-010	
	S-013	
	S-015	
S-090-MC	S-017	

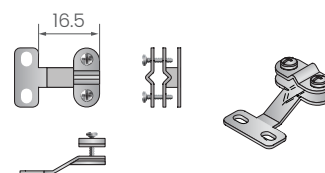

**S-090-M**

cable clamp

### Cable grommet, Type S-092-M

S-092-M.. seal is mounted in connector's hole for preventing of moisture and dirt. It is used mainly with small diameter cables.

#### Order code

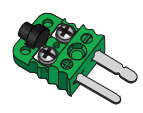
Connector grommet	
S-092-M.	

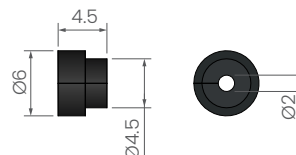

**S-092-M**

cable grommet



### Sleeve for miniature connector, Type S-095-M

S-095-M sleeve is designed for soldering or crimping mineral insulated cable or insulated thermocouple cable.

#### Order code

Material: brass

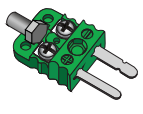
Sleeve	A	B	
S-095-M-1.1	1.10	2.40	
S-095-M-1.6	1.60	2.40	
S-095-M-2.1	2.10	3.20	
S-095-M-3.1	3.10	4.50	

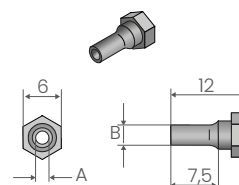

**S-095-M**

sleeve

